

82 Worman's Mill Ct
Suite G
Frederick, MD 21701
Phone: 301-695-0880
Fax: 301-293-6009

TOWN OF TOWN OF EMMITSBURG, MD DePaul Street Waterline Pre-Bid Agenda

ADDENDUM NO. 5

This Addendum shall be incorporated into and form a part of the Contract Documents it shall modify the original Bidding Documents dated January 5, 2024, as noted below. All bids shall be based on this Addendum, in accordance with the bidding documents. Bidder must acknowledge receipt of this Addendum in the space provided on the Bid Form. Failure to do so may subject Bidder to disqualification.

This Addendum consists of FIFTEEN (15) pages.

- 1) Is there any charge by the town for road opening or noise control permits?
 - No fees will be charged.
- 2) Please advise the bidders list for the project
 - No bidders list is available.
- 3) What is the engineers estimate for the project?
 - Provided as part of this addendum.
- 4) Do the entire bid documents get submitted as the bid, or just the proposal forms/pages?
 - Only submit the necessary bid forms.
- 5) Do the forms in Section 3 Clause get submitted with the bid or with the contract when executed? (Maryland department of Housing and community development)
 - The Section 3 Clause can be submitted to the owner, prior to the owner's award of the contract.
- 6) Please confirm the good faith efforts are to be submitted after bidding but prior to contract award

- Good faith efforts are to be submitted to the owner, prior to the owner's award of the contract.
- 7) What is the existing water main material?
- Based on the pipes age, most likely cast iron
- 8) Is the new water main to have restrained joints or Push on joints?
- Push on joints
- 9) The town is performing the water testing and sampling, is that for the temporary bypass as well?
- Bacterial testing only shall be performed by the Town. The contractor is responsible for all other testing.
- 10) As there is no specification for the temporary bypass, is Yellowmine an acceptable product?
- Specifications have been provided in this Addendum. A pipe that is watertight and pressure rated for 200 psi operating pressure and certified for potable water is acceptable.
- 11) For the bypass should the contractor assume 2" for domestic service and 4" for fire flows (hydrant coverage)?
- Temporary lines should be 4" minimum.
- 12) The drawings indicate a 6" Temporary bypass on Phase 2, is this to provide water for the bypass in phase 1?
- Yes. A bypass pipe is needed to avoid a dead-end system.

As this bypass is being installed where an existing 6" Water main was that had tuberculation, will a 4" line be suitable instead of the 6"? or can the new main be installed in a trench next to the existing 6" main and eliminate the temporary bypass in this section? As this section appears to be a flood plain there is a risk of the temporary piping to be submerged.

- A 4" line will be acceptable.
 - The new waterline must be installed in the same trench as the existing. Our permit does not allow additional disturbance.
- 13) For temporary service connections to the homes, will the service hose be connected to outside sillcocks, or excavations at the curb stops?

- Preference will be a connection to the hose bib. If the hose bib is not accessible or not existing then a connection to the curb stop will be required.
- 14) Where the temporary bypass crosses street intersections, is the restoration paid under the line items?
- Excavation and backfill shall be included in the Lump Sum bid Price. Asphalt restoration will be paid under Bid Item 1015.
- 15) How many temporary fire hydrants will be required?
- Fire hydrants should be spaced every 500 feet. The number will depend on each contractor's phasing plan.
- 16) Will/ Do the apartment buildings on Depaul street have $\frac{3}{4}$ " service or should it be upsized?
- Please see the revised Proposal Form. 50-52 DePaul St. shall be 1.5" and 51 DePaul St shall be 3" services.
- 17) Are the 6" lines on Federal Ave and St Josephs Lane able to be isolated without putting any customers out of water, or will a cut a cap utilizing a thrust block be necessary?
- The Town should be able to isolate the area in question.
- 18) The sections of concrete encasement contain multiple house services. Does the town want these services encased or should they be "boxed out" and left accessible?
- The services should not be encased in concrete.
- 19) Is the existing 6" valve/ main restrained at the Eastern tie in point?
- This is unknown.
- 20) Under the Bid Submission for the documents that need to be included in the bid packet, I can't find the Section 3 compliance bid form (I found one that says Section 3 Clause, I didn't know if that was this form or not) and the Contractor Debarment request.
- 21)
- Please refer to the updated list of required bid documents.
- 22) Also there are 2 affidavit's listed on there. I printed one that says Bidder Affidavit and another one that is just affidavit. Are those the correct ones?

- Please refer to the updated list of required bid documents.

23) It also says 5 hard copies to be submitted. Is that the original and 4 copies?

- Five copies total including the original is acceptable.

1. Bid Submission:

A. Bids shall be enclosed in one envelope which includes:

Proposal Cover Page - 59

Proposal Form - 62

Bidder Certification of Work Capacity - 66

Affidavit of Qualification to Bid – 67

Maryland Community Development Block Grant Program Contractor Statement of Assurances and Certifications – 69

Section 3 Hiring/Labor Hours Estimate Form Bid Solicitation/Sole Source Solicitation – 73

Bid Bond - 77

Bidder's Affidavit – 85

Certification by proposed prime or subcontractor regarding equal employment Opportunity - 91

Bidder's Certificate of Work Capacity – 93

Subcontractor Listing - 94

Affidavit – 104

Build America, Buy America Certification for CDBG Project Contractors and Subcontractors – 167-169

Request for Contractor Debarment Check- 171

END OF ADDENDUM NO.5

DEPAUL STREET WATERLINE REPLACEMENT PROJECT
TOWN OF EMMITSBURG, MD
PROJECT MANUAL

Town of Emmitsburg DePaul Street Waterline Replacement Project Phases 1 & 2

PROPOSAL FORM

Date: _____

NAME OF FIRM: _____

ADDRESS: _____

PHONE: _____

FAX: _____

CONTACT NAME: _____

EMAIL: _____

Part A: Phase 1 Base Bid Items

Item No.	Quantity	Description	Unit	Unit Price	Total Price
1001	1	Mobilization (Maximum 10% of Total For Base Bid Items)	LS		
1002	1	Maintenance of Traffic - Includes All Personnel, Construction Signs - Complete including installation and removal	LS		
1003	1	Geotechnical Inspection and Testing	LS		
1004	1	Construction Stakeout	LS		
1005	1	Provide, Install & Maintain Sediment & Erosion Control Devices	LS		
1006	2,049	Furnish and Install 8" Class 52 Ductile Iron Pipe includes all valves, bends, fittings, connection to existing lines, pressure testing, chlorination, trench & backfill	LF		
1007	5	Furnish and Install New 6" MJ Fire Hydrant includes all appurtenances, trench & backfill	EA		
1008	20	Furnish and Install 3/4" Copper Type 'K' Water Service with New Curb Stop includes all appurtenances, trench & backfill. Long Side	EA		
1009	22	Furnish and Install 3/4" Copper Type 'K' Water Service with New Curb Stop includes all appurtenances, trench & backfill. Short Side	EA		

DEPAUL STREET WATERLINE REPLACEMENT PROJECT
TOWN OF EMMITSBURG, MD
PROJECT MANUAL

1010	1	Provide Install and Maintain temporary above-ground water system.	LS		
1011	1	Cap Existing 6" Watermain includes all appurtenances, trench & backfill	EA		
1012	440	Restoration of Concrete Curb & Gutter	LF		
1013	760	Restoration of Concrete Sidewalk	SF		
1014	25	Restoration of Asphalt Driveway Aprons.	SY		
1015	1,800	Full Depth Asphalt Trench Repair. Includes 12" CR6 or GAB Base, 4" HMA Base Course 19.0mm Superpave PG64-22 and 2" Asphalt Surface HMA Surface Course 12.5mm Superpave PG64-22	SY		
1016	20	24" White Waterborne Paint Stop Bar	LF		
1017	425	4" White Waterborne Paint Pavement Marking	LF		
1018	77	12" White Waterborne Paint Crosswalk	LF		
1019	3	Remove and Reset existing Street Sign	EA		
1020	1	Site Restoration landscaping - Includes topsoil, seed & straw	LS		
1021	200	Cold Patch for Maintenance of Traffic	TON		
1022	1	Furnish and Install 1 1/2" Copper Type 'K' Water Service with New Curb Stop includes all appurtenances, trench & backfill for 50-52 DePaul St.	EA		
1023	1	Furnish and Install 3" Copper Type 'K' Water Service with New Curb Stop includes all appurtenances, trench & backfill for 51 DePaul St.	EA		
TOTAL FOR PHASE 1 BASE BID ITEMS					

DEPAUL STREET WATERLINE REPLACEMENT PROJECT
TOWN OF EMMITSBURG, MD
PROJECT MANUAL

Part B: Phase 2 Base Bid Items

Item No.	Quantity	Description	Unit	Unit Price	Total Price
2001	1	Mobilization (Maximum 10% of Total For Base Bid Items)	LS		
2002	1	Geotechnical Inspection and Testing	LS		
2003	1	Construction Stakeout	LS		
2004	1	Provide, Install & Maintain Sediment & Erosion Control Devices	LS		
2005	400	Furnish and Install 8" Class 52 Ductile Iron Pipe includes all valves, bends, fittings, connection to existing lines, pressure testing, chlorination, trench & backfill	LF		
2006	1	Provide Install and Maintain temporary above-ground water system.	LS		
2007	1	Site Restoration landscaping - Includes topsoil, seed & straw	LS		
2008	20	24" ALCMP includes trench & backfill	LF		
TOTAL FOR PHASE 2 BASE BID ITEMS					

Part C: Contingent Unit Price Items

Item No.	Quantity	Description	Unit	Unit Cost	Extension
3001	100	Excavation Below Subgrade for Unsuitable Soil	CY		
3002	100	Backfill with select material	CY		
3003	20	Additional Test Pits	CY		
3004	100	Furnishing and Placing Crusher Run (CR-6)	TON		
3005	100	Furnish, Install and Maintain 8" Filter Log	LF		
TOTAL FOR CONTINGENT ITEMS					

SECTION 22 11 14
TEMPORARY WATERMAIN BYPASS

PART 1 - GENERAL

1.01 - DESCRIPTION:

- A. Under this Item, the Contractor shall furnish, install, make the necessary connections, maintain and remove the bypass pipe and fittings required to maintain a temporary water main bypass and services as shown on the plans or as ordered by the Engineer, in such a manner as to provide constant adequate water supply to consumers and to avoid impeding vehicular and pedestrian traffic and access to abutting properties.

1.02 - MATERIALS:

- A. In accordance with Code of Maryland (COMAR) 26.04.01.33, materials used in the manufacture of public water supply components, appurtenances, pipe, storage tank, valve, fixture or other materials which come in contact with water intended for public water supplies must meet the applicable American National Standards Institute (ANSI)/National Sanitation Foundation (NSF 61 NAD NSF 372) standards for direct or indirect drinking water additives. This applies to any product which comes in contact with water intended for use in a public water supply.
- B. Temporary bypass pipe must be drawn from water main equipment stocks that are dedicated exclusively for use in pipe projects involving fresh potable water.
- C. Temporary bypass pipe shall be PVC or steel having a minimum working pressure rating of 200 pounds per square inch with restrained couplings.
- D. Water service hose to be used for connection from the temporary bypass pipe to the building/residence shall have a minimum working pressure rating of 200 pounds per square inch and be made of a material that will not have an adverse effect on the taste or odor of the water.
- E. The materials selected shall be adequate to operate at the pressure to which they will be subject to and adequate to withstand whatever forces, such as traffic loading, they will encounter. Joints for all pipe shall be watertight.
- F. The Town reserves the right to reject at any time materials that do not meet the requirements set forth herein.

1.03 - CONSTRUCTION DETAILS:

- A. The Contractor shall make all connections to the customer's water service line on a day and at a time that is convenient to the customer.

- B. Connection from the temporary bypass pipe to the water service line shall be made inside the building at the meter, outside at the hose bib, or any suitable area not directly in the street.
- C. Hose shall be run into the building through a window, or a temporary opening shall be made in the building wall of a size just large enough to pass the hose through. Dryer vents are not to be used. The opening shall be secured to prevent any access by unauthorized individuals and shall be completely sealed to prevent access by rodents, water intrusion, and to minimize heat loss.
- D. Hose connection made at the hose bib shall be done by connecting a 2 hose Y-adaptor with dual shutoff capable of allowing independent use of two hoses from one faucet.
- E. If access into the building is impossible or impractical, and the hose bib is not accessible, the connection shall be made to the water service line in any suitable area not directly in the street. The Contractor shall excavate, expose and cut the water service line, and connect the hose. The Contractor shall either backfill excavated area or install orange construction fencing with flashers around the excavated area. If the area where the excavation is made is paved, the Contractor shall cover the excavation with heavy gauge steel plates capable of supporting an AASHTO H20 Highway Loading.
- F. The Contractor shall make satisfactory arrangements with the customer so that valves shall be accessible at all times.
- G. Temporary water mains shall be laid above ground in the street right-of-way or in the utility easement adjacent to the street along both sides of the street. Rubber, steel or asphalt cold patch ramps shall be placed at the driveways crossing these temporary mains to protect the mains from traffic. These mains shall connect to fire hydrants outside of the project limits and will serve to keep the customers within the project limits served with water.
- H. All by-pass pipes that cross handicapped ramps, intersections, or extends around the radius of an intersecting street shall be installed below the surface grade.
- I. Contractor shall make all required excavation, backfill, and compaction as well as furnishing the necessary equipment and pipe for temporary Water Mains.
- J. All temporary Water Mains shall be chlorinated, flushed, and a satisfactory bacteriological sample obtained by and tested by a certified State of Maryland testing laboratory prior to placing them in service for each location.
- K. The temporary main shall be disinfected and laboratory tested to meet water quality standards. Temporary services shall then be connected at the customer's hose bib or meter setting to provide continued water service throughout the project. The connection of the water service line to the

temporary main shall be made using a clean flexible 3/4" pipe connected to the hose bib or meter setting inside of the meter crock. The 3/4" hose shall be heavy-duty, abrasion resistant, flexible rubber, 100 feet long with a pressure rating greater than the maximum pressure of the distribution system.

1.04 Construction Sequencing

- A. The Contractor shall develop a comprehensive sequence of construction detailing the successive phases of the temporary bypass and watermain installation. The sequence of construction shall be submitted to the Engineer with the project schedule for comment and review in accordance with Section 01100.
- B. The Contractor's sequence of construction shall be consistent with the outline; however, the Contractor shall be responsible for effectively sequencing and coordinating all aspects of the work in accordance with the general requirements the Contract Documents. The approved sequence of construction shall be incorporated into the aforementioned project schedule.
- C. During construction and installation of the temporary bypass main, the Contractor shall provide necessary traffic control devices in order to maintain traffic and access to ensure that residents have full access at all times.
- D. The Contractor shall schedule in advance with the Town any watermain shutdown.

1.05 - Cutting and Plugging (Capping) Existing Watermain.

- A. Complete the installation of the temporary bypass watermain and transfer all affected water services. Coordinate with the Town to shut down the existing waterline before cutting and plugging the line(s). Cut the existing pipe at the point designated on the plans or by the Engineer. Use a cutting method approved by the Engineer. Use mechanical joint plugs and/or caps, as required in connection with the work under this item, manufactured in accordance with AWWA Specification C-110. After installing the plug or cap, install a blocking or restraint system to adequately brace the plug or cap.
- B. The Contractor shall notify all water consumers affected by a water shutdown of the approximate length of the shutdown at least 24 hours in advance

1.06 - 24 Hour Maintenance

- A. The Contractor shall be responsible for maintenance and repair of the temporary bypass system. The Contractor shall be equipped to make all repairs necessary, at the Project site, for the duration of the installation. The Town of Walkersville shall be provided with a 24-hour emergency telephone number at which the Contractor may be reached, in case it is necessary to make any repairs.

PART 2 MEASUREMENT AND PAYMENT

2.01 - METHOD OF MEASUREMENT:

- A. The work will be measured as the lump sum price bid for furnishing, installing, chlorinating, maintaining and removing the temporary watermain bypass. Payment shall include furnishing all pipe, fittings, valves, hoses, stone-dust, cold patch, barricades, temporary meter pit covers, chlorine and other materials necessary to install the by-pass system.
- B. The Cutting and Plugging (Capping) of Existing Watermains will not be measured for payment but will be considered incidental to the Contract.

2.02 - BASIS OF PAYMENT:

- A. The lump sum price shall include all labor, excavation, backfill, equipment, and materials necessary to satisfactorily complete the work. This shall include relocation and reuse of the temporary main and service connections for each phase of the project as indicated by the contractor.

END OF SECTION



Est. 1966

ENGINEERS
SURVEYORS
PLANNERS
LANDSCAPE ARCHITECTS

82 Worman's Mill Ct Suite G Frederick, MD 21701

Phone: 301-695-0880

Fax: 301-293-6009

E-mail: foxfrederick@foxassociatesinc.com

PREPARED BY: J. CECI

CHECKED BY:

DATE: 5/16/2023

JOB NAME: DePaul St. Waterline

JOB NUMBER: 23-31966

SHEET NUMBER: 1 OF 1

ENGINEER'S ESTIMATE - WATERLINE INSTALLATION

	ITEM	QUANTITY	UNIT	INSTALLED UNIT PRICE	TOTAL
1	Mobilization (Maximum 10% of Total For Base Bid Items)	1	LS	\$ 67,862.50	\$ 67,862.50
2	Maintenance of Traffic	1	LS	\$ 30,000.00	\$ 30,000.00
3	Geotechnical Inspection and Testing	1	LS	\$ 7,000.00	\$ 7,000.00
4	Construction Stakeout	1	LS	\$ 10,000.00	\$ 10,000.00
5	Furnish and Install 8" Class 52 Ductile Iron Pipe	1,800	LF	\$ 110.00	\$ 198,000.00
6	Furnish and Install New 6" MJ Fire Hydrant	4	EA	\$ 5,000.00	\$ 20,000.00
7	Furnish and Install 3/4" Copper Type 'K' Water Service with New Curb Stop.	44	EA	\$ 2,500.00	\$ 110,000.00
8	Provide Install and Maintain Filter Log or Silt Fence.	200	LF	\$ 20.00	\$ 4,000.00
	Provide Install and Maintain Inlet Protection	10	EA	\$ 750.00	\$ 7,500.00
9	Provide Install and Maintain temporary above-ground water system.	1	LS	\$ 42,000.00	\$ 42,000.00
10	Asphalt Trench Repair. Includes 12" CR6 or GAB Base and 6" (2-3" lifts) HMA Base Course 25.0mm Superpave PG64-22	2,000	SY	\$ 84.00	\$ 168,000.00
11	Restoration of Concrete Curb & Gutter and Concrete Sidewalk and Driveway Aprons.	1	LS	\$ 24,000.00	\$ 24,000.00
12	Site Landscape Restoration Includes Median Landscaping	1	LS	\$ 10,000.00	\$ 10,000.00
13	Cold Patch for Maintenance of Traffic	275	TON	\$ 175.00	\$ 48,125.00
14					\$ -
15					\$ -

SUB-TOTAL \$ 746,487.50
 15% CONTINGENCIES \$ 111,973.13
 TOTAL BASE BID: \$ 858,460.63

Additional Cost for Davis-Bacon Wage Rate 15% \$ 128,769.09
 Additional Cost For Buy American 10% \$ 85,846.06



**ENGINEERS
SURVEYORS
PLANNERS
LANDSCAPE ARCHITECTS**

82 Worman's Mill Ct Suite G Frederick, MD 21701

Phone: 301-695-0880

Fax: 301-293-6009

E-mail: foxfrederick@foxassociatesinc.com

PREPARED BY: J. CECI

CHECKED BY:

DATE: 2/18/2019

JOB NAME: DePaul St. Waterline

JOB NUMBER: 18-31415

SHEET NUMBER: 1 OF 1

ENGINEER'S ESTIMATE - CONTINGENCY ITEMS

	ITEM	QUANTITY	UNIT	INSTALLED UNIT PRICE	TOTAL
1	Excavation Below Subgrade for Unsuitable Soil	100	CY	\$ 25.00	\$ 2,500.00
2	Backfill with select material	100	CY	\$ 40.00	\$ 4,000.00
3	Additional Test Pits	40	CY	\$ 100.00	\$ 4,000.00
4	Furnishing and Placing Crusher Run (CR-6)	100	TON	\$ 140.00	\$ 14,000.00
5	Furnish and Install Fire Hydrant	1	EA	\$ 5,000.00	\$ 5,000.00
6					\$ -
7					\$ -
8					\$ -
9					\$ -
10					\$ -
11					\$ -
12					\$ -
13					\$ -
14					\$ -
15					\$ -
16					\$ -
17					\$ -
18					\$ -
19					\$ -
20					\$ -
21					\$ -
22					\$ -
23					\$ -
24					\$ -
25					\$ -
26					\$ -
27					\$ -
28					\$ -
29					\$ -
30					\$ -
31					\$ -
32					\$ -
33					\$ -
34					\$ -

SUB-TOTAL \$ 29,500.00
 15% CONTINGENCIES \$ 4,425.00
TOTAL CONTINGENCY ITEMS: \$ 33,925.00

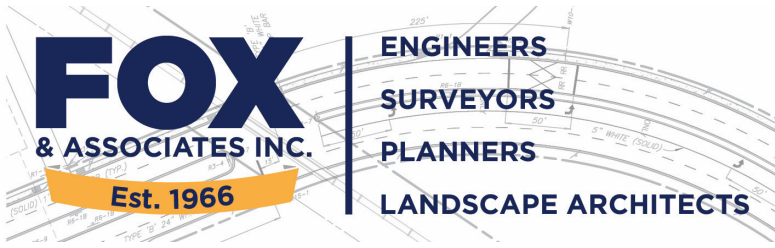

82 Worman's Mill Ct Suite G Frederick, MD 21701

Phone: 301-695-0880

Fax: 301-293-6009

E-mail: foxfrederick@foxassociatesinc.com

PREPARED BY: J. CECI

CHECKED BY:

DATE: 10/30/2023

JOB NAME: DePaul St. Waterline Phase

JOB NUMBER: 23-31966

SHEET NUMBER: 1 OF 1

ENGINEER'S ESTIMATE - WATERLINE INSTALLATION

	ITEM	QUANTITY	UNIT	INSTALLED UNIT PRICE	TOTAL
1	Furnish and Install 8" Class 52 Ductile Iron Pipe	400	LF	\$ 110.00	\$ 44,000.00
2	Provide Install and Maintain Filter Log or Silt Fence.	450	LF	\$ 20.00	\$ 9,000.00
3	24" ALCMP	20	LF	\$ 150.00	\$ 3,000.00
4	Provide Install and Maintain temporary above-ground water system.	1	LS	\$ 9,000.00	\$ 9,000.00
5	Site Landscape Restoration Includes Median Landscaping	1	LS	\$ 3,000.00	\$ 3,000.00
6					
7					
8					
9					
10					\$ -
11					\$ -
12					\$ -
13					\$ -
14					\$ -
15					\$ -

SUB-TOTAL \$ 68,000.00
 15% CONTINGENCIES \$ 10,200.00
 TOTAL BASE BID: \$ 78,200.00

Additional Cost for Davis-Bacon Wage Rate 15% \$ 11,730.00
 Additional Cost For Buy American 10% \$ 7,820.00

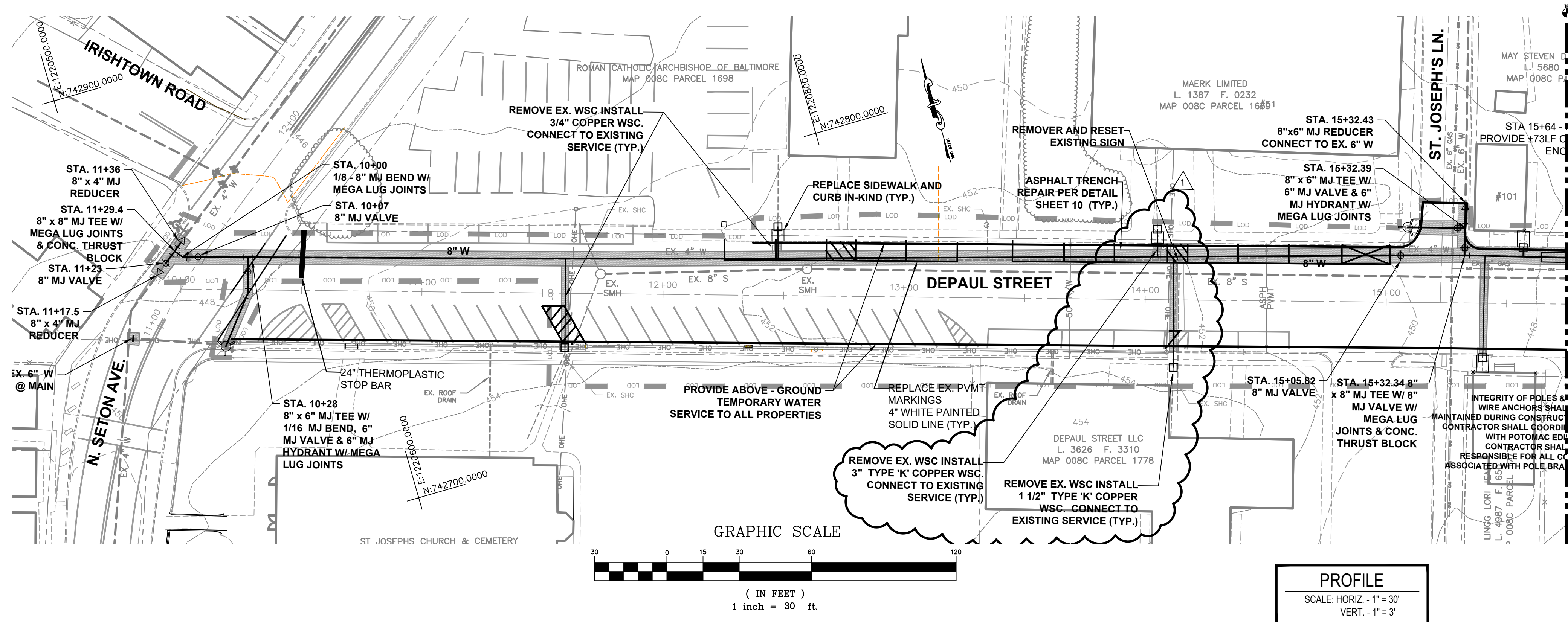

- NOTES:
- CONTRACTOR MUST TEST PIT EXISTING UTILITIES TO VERIFY EXACT HORIZONTAL AND VERTICAL LOCATION. THE CONTRACTOR SHALL NOTIFY THE ENGINEER AND INSPECTOR OF ANY DISCREPANCIES.
 - EXCAVATED MATERIAL SHALL BE PLACED ON THE HIGH SIDE OF THE TRENCH. ALL TRENCHES SHALL BE BACK-FILLED AND STABILIZATION ON ALL DISTURBED AREAS SHALL OCCUR AT THE END OF EACH WEEK, EXCEPT FOR THE PORTION NECESSARY TO RESUME CONSTRUCTION. ANY DISTURBED AREAS OR STOCKPILES NOT STABILIZED AT THE END OF EACH DAY SHALL BE PROTECTED AND HAVE SEDIMENT CONTROLLED BY THE USE OF STRAW BALE DIKES, EARTH BERMS AND SILT FENCES AS DIRECTED BY THE SEDIMENT CONTROL INSPECTOR.
 - ROADWAY EMBANKMENT STRUCTURAL FILL SHALL BE COMPACTED TO 95% MAXIMUM DRY DENSITY PER ASSHTO T-180 METHOD "C". UTILITY TRENCH STRUCTURAL FILL SHALL BE COMPACTED TO 95% MAXIMUM DRY DENSITY ASSHTO T-99 METHOD "A" OR AS MODIFIED BY THE GEOTECHNICAL ENGINEER.
 - ALL EXISTING WATERMAIN THAT IS BEING REPLACED BY THIS CONTRACT SHALL BE REMOVED AND DISPOSED OF BY THE CONTRACTOR.
 - ALL WATERMAIN SHALL HAVE 3'-6" MINIMUM COVER BELOW EXISTING GROUND.
 - THE CONTRACTOR SHALL COORDINATE SHUT DOWN WITH TOWN OF EMMITSBURG PERSONNEL.
 - CONTRACTOR IS RESPONSIBLE TO MAINTAIN THE INTEGRITY OF POLES & GUY WIRE ANCHORS DURING CONSTRUCTION. CONTRACTOR SHALL COORDINATE WITH FIRST ENERGY TO DETERMINE THE NEED FOR POLE BRACING.

TEMPORARY WATER SERVICE

THE CONTRACTOR SHALL PROVIDE A TEMPORARY WATER SERVICE LINE FOR THIS PROJECT. THE TEMPORARY SERVICE LINE MUST BE PLACED IN A MANNER THAT ALLOWS INGRESS/EGRESS TO PRIVATE PROPERTY AND PUBLIC STREET ALLEYS. THE CONTRACTOR SHALL PREPARE A DETAILED TEMPORARY SERVICE PLAN AND SUBMIT IT FOR TOWN APPROVAL PRIOR TO STARTING CONSTRUCTION. THE SEQUENCE OF CONSTRUCTION SHALL BE DETERMINED BY THE ENGINEER.

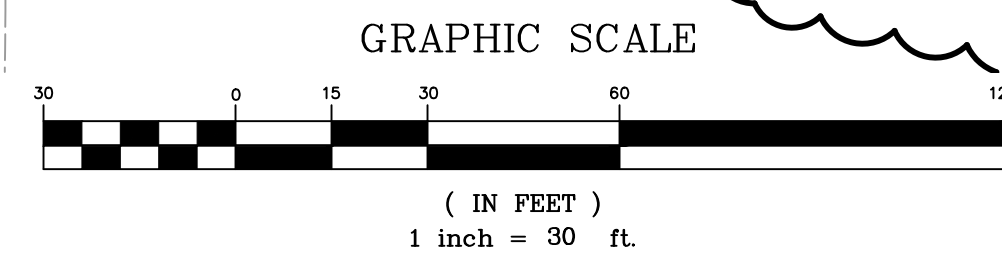

PROFILE
SCALE: HORIZ. - 1" = 30'
VERT. - 1" = 3'

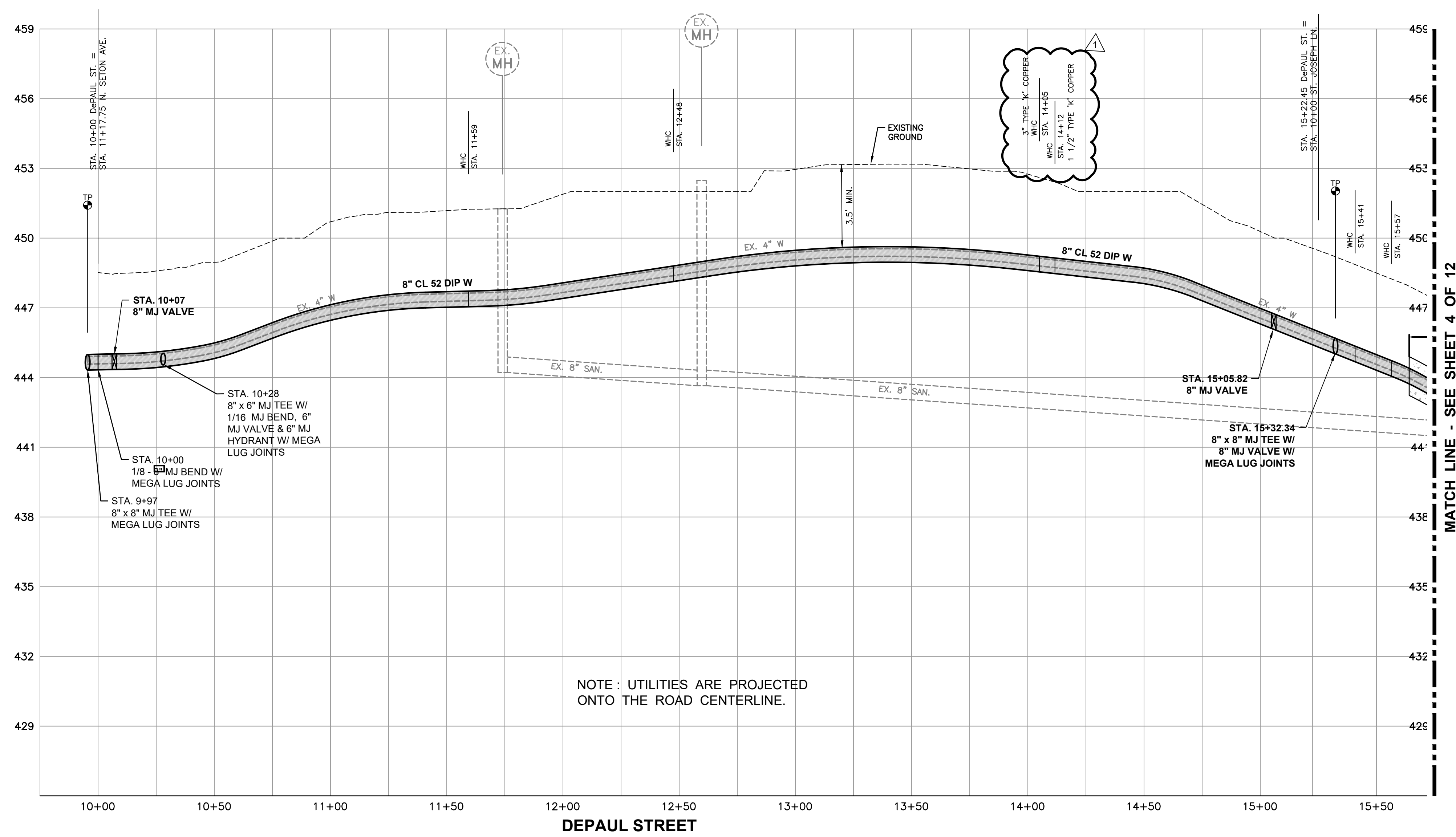

NOTE: UTILITIES ARE PROJECTED ONTO THE ROAD CENTERLINE.

FOX & ASSOCIATES INC.
Est. 1966

ENGINEERS-SURVEYORS-PLANNERS

82 MORMANS MILL COURT
SUITE 'G'
FREDERICK, MD. 21701
PHONE: (301) 695-0880
FAX: (301) 293-6009
WWW.FOXASSOCIATESINC.COM Email: FOX@FOXASSOCIATESINC.COM

DRAWN BY:	
REVISION	
REVISOR	
DATE	01/31/24

WATER MAIN PLAN AND PROFILE

TOWN OF EMMITSBURG

DEPAUL ST WATER MAIN REPLACEMENT

PHASE 1

SITUATED ALONG DEPAUL STREET

TOWN OF EMMITSBURG

FREDERICK COUNTY, MARYLAND

BID SET 12/22/2023

APPROVED BY:

TOWN OF EMMITSBURG

TOWN MAYOR _____ DATE _____

TOWN PLANNING DEPARTMENT _____ DATE _____

SCALE: AS NOTED

PROFESSIONAL CERTIFICATION

I HEREBY CERTIFY THAT THESE DOCUMENTS WERE PREPARED OR APPROVED BY ME, AND THAT I AM A DULY LICENSED PROFESSIONAL ENGINEER UNDER THE LAWS OF THE STATE OF MARYLAND.

LICENSE NO. 92709 EXP. DATE 7/23/24

FREDERICK SOIL CONSERVATION DISTRICT

SOIL EROSION AND SEDIMENT CONTROL PLAN APPROVAL

By: _____ DISTRICT MANAGER OR DESIGNEE

Date: _____

PLAN IS VALID FOR TWO YEARS FROM DATE OF APPROVAL.

PROJECT NO.	23-31966
DRAWING NO.	D-3609
DATE:	DECEMBER 2023
DRAWN BY:	JHC
CHECKED BY:	JHC

OWNER / DEVELOPER

TOWN OF EMMITSBURG, MARYLAND
300A SOUTH SETON AVE.
EMMITSBURG, MD 21727

SOD APPROVAL FOR SEDIMENT AND EROSION CONTROL IS IN ACCORDANCE WITH THE 2011 MARYLAND STANDARDS AND SPECIFICATIONS FOR SOIL EROSION AND SEDIMENT CONTROL AND IS CONTINGENT UPON ISSUANCE OF ALL APPLICABLE REGULATORY PERMITS.